



The Aspire Hotel Sydney is a gem of a boutique hotel tucked into a quiet, tree-lined street just minutes away from the Darling Harbour Precinct and Sydney CBD. Neighbourhood attractions include the Powerhouse and Sydney Maritime Museums, the Imax Theatre, Chinatown, Star City Casino and the restaurants of Cockle Bay Wharf and Darling Harbour. All are easily accessible by light rail or short walk.

Spacious, quiet rooms offer balconies opening to fresh air, city views, ensuite with bath and all the amenities required by the corporate or leisure traveller. Other facilities include meeting rooms with natural light and outdoor access, on-site secure parking for delegates and guests, dining room and 24-hour reception and business centre.

The Aspire Hotel Sydney is a neighbourhood hotel with Sydney at its doorstep.

ASPIRE HOTEL SYDNEY

383 - 389 Bulwara Road, Ultimo NSW Australia 2007

T: 61 2 9211 1499 F: 61 2 9281 3764

E: EdytaR@MetroHG.com W: www.MetroHotels.com.au

ROOM FLOOR PLANS

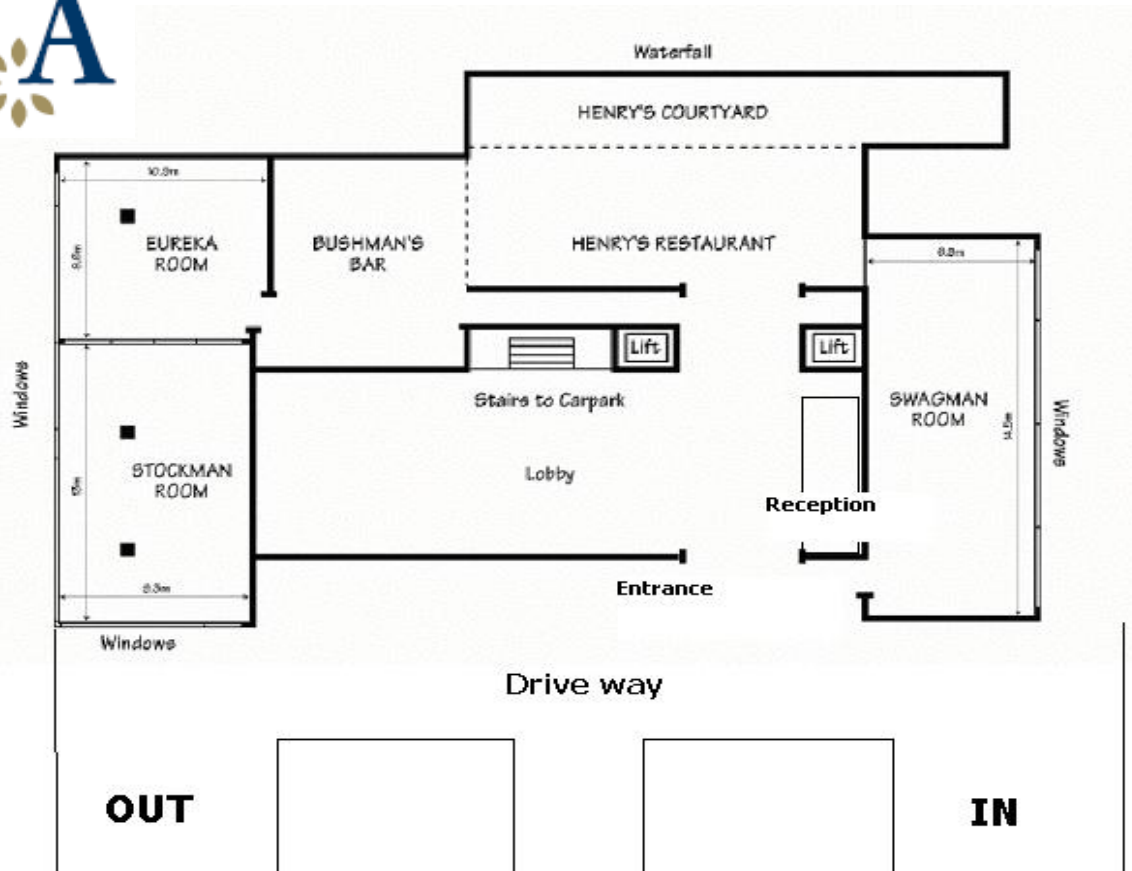

ROOM NAME	HEIGHT (M)	AREA (M)	BOARD ROOM	THEATRE	CLASS ROOM	U - SHAPE	BANQUET	COCKTAIL
Henry's Restaurant	--	--	--	--	--	--	180	280
Ball Room (A + B)	2.4	22.7 x 9	40	100	60	30	110	220
Eureka (A)	2.4	9.7 x 10.5	25	40	24	18	40	100
Stockman (B)	2.4	13 x 9	30	60	36	30	70	120
Swagman	2.3	14.6 x 7.1	40	60	45	30	70	120

ROOM NAME	FULL DAY	HALF DAY & EVENING (4 hours or less)
Ball Room (A + B)	\$700 - \$900	\$550 - \$750
Eureka (A)	\$500 - \$650	\$350 - \$500
Stockman (B)	\$500 - \$650	\$350 - \$500
Swagman	\$550 - \$700	\$400 - \$600

CONFERENCE AND FUNCTION FACILITIES

Three rooms can cater for functions of up to 130 people. Every room has natural light, direct-dial telephone links and individual air conditioning controls.

All conference rooms are located on the ground floor for easy access and can be secured during breaks. Private access to Mary Ann Park next to the hotel provides refreshing space for outdoor breaks, activities and catering.

Choose from a selection of packages and catering options to suit all tastes and budgets. Alternatively, conference organisers can plan their individual catering needs with the hotel's Conference staff to ensure a professionally run event, delivered on time and with quality.

CONFERENCE PACKAGES

Packages include the following but may be customised according to requirements:

Room hire from 0830 hrs - 1700 hrs

Meeting room set-up

Arrival tea and coffee

Morning tea, coffee and baked muffins

Lunch, please see below

Afternoon tea, coffee and cookies

Pads, pens, water and mints

Whiteboard and flipchart with markers and duster, screen and overhead projector

Bulwara Package \$59.00 per person (minimum 15 delegates)*

Lunch Option:

Working lunch with assorted sandwiches and wraps, fresh fruit platter, tea and juice

* Less than 15 delegates add \$5.00 per person

Ultimo Package \$69.00 per person (minimum 15 delegates)*

Lunch Option:

Seated lunch in Henry's Restaurant with choice of conference menu

* Less than 15 delegates add \$10.00 per person



LOCATION

Address:

383 – 389 Bulwara Road
ULTIMO NSW Australia 2007
T: 61 2 9211 1499
F: 61 2 9281 3764
E: EdytaR@MetroHG.com
W: www.MetroHotels.com.au

Transport:

Airport:

Sydney (12 km) - shuttle available

Sydney Rail:

Central Station (10 minute walk)

Rail Light rail:

Haymarket (5 minute walk)

Monorail:

Paddy's Market (5 minute walk)

Car:

Secure onsite parking



FACILITIES

Guest Rooms: 96 large, well appointed rooms with ensuite, individual air conditioning control, wireless internet connectivity, safe, iron & board, hairdryer, tea and coffee making facilities and fridge.

Restaurant: Henry's Restaurant opens daily for Breakfast

Meeting and Banquet: Three function rooms with capacity for up to 280 people

LOCAL AREA

Commercial Venues:

Sydney Convention and Exhibition Centre
Entertainment Centre
Star City Casino
University of Technology Sydney
Australian Broadcasting Corporation (studios)
Theatre District

Attractions:

Powerhouse Museum
Maritime Museum
Paddy's Markets
Chinatown
Sydney Aquarium
Darling Harbour & Cockle Bay Wharf restaurants