



MUSEUMSPACES

RA

# Immigration Museum

**A stately city oasis, Immigration Museum is located on Flinders Street in Melbourne's heritage-listed Old Customs House building, overlooking the Yarra River.**

Long Room, Immigration Museum







# From Tall Ceilings to Long Rooms

**From stunning heritage details to flexible, contemporary spaces—Immigration Museum can be a blank canvas for your ideas or the setting for an immersive experience. And we're happy to help you customise the details.**

## Location

Immigration Museum is a reimagining of Old Customs House, one of Melbourne's most significant 19th century buildings. At the business end of Flinders Street—where merchants once unloaded their cargo—we're still surrounded by the bustle of the city, but lovingly restored to recall Melbourne's history. Architecturally, the building connects grand Victorian design with modern detail—from the original bluestone vaults to the transparent Atrium overlooking our sunny Courtyard and Tribute Garden. We are a few steps from Collins Street trams and Flinders Lane car parking, a short walk from the city's major rail hubs and a quick stroll from Southbank and the Melbourne Convention and Exhibition Centre.

## Event Services

We love helping to transform the spaces at Immigration Museum. Whether you need outdoor lighting as the sun sets on our Courtyard, or a private exhibition viewing, we're always flexible and happy to customise your floor plan.

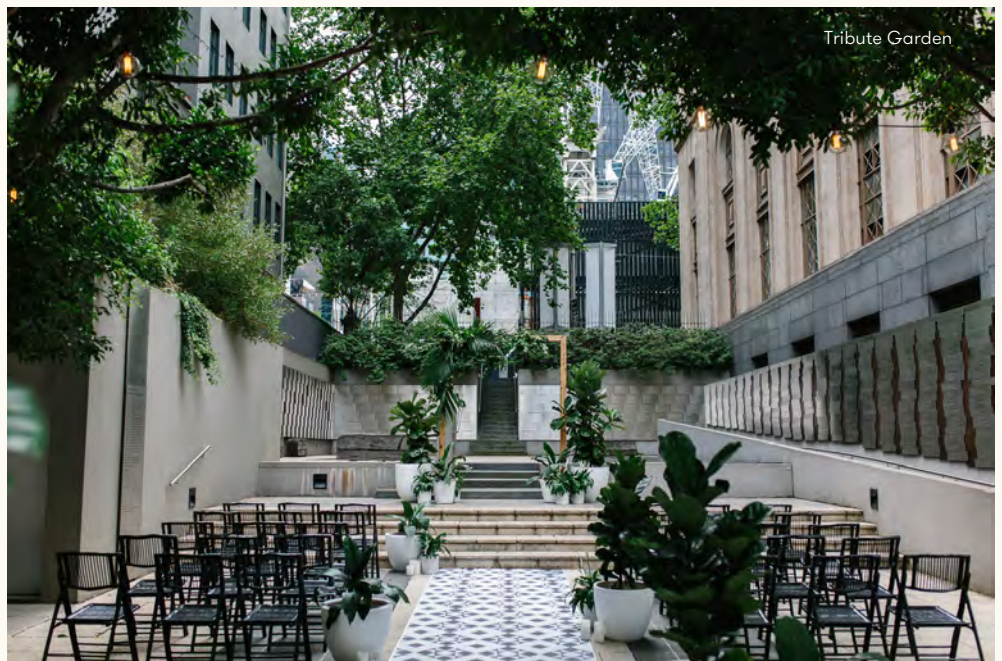









**Making an event your own is all about the detail, but first you need a beautiful space. Here the fun starts—we love to create personalised plans for unique events. Whether it's a sit-down banquet, cocktails at sunset or professional gatherings, we're sure we can suit your needs in style.**

### Long Room

The Palazzo-style Long Room, with its tall ceilings and iconic columns offering 335m<sup>2</sup> of versatile floor space, that once greeted jostling crowds of travellers arriving in Marvellous Melbourne. Inspiring in its size, the Long Room is ideal for a soiree for up to 300 guests. Typically home to many unique exhibitions, you can be rest assured the Long Room is available for an exclusive period for your guests to enjoy a memorable experience.

### Grand Foyer

Black and white checkerboard marble floors carefully re-instated to its original design, and high detailed ceilings give the Grand Foyer a sense of old-world sophistication and opulence. The Grand Foyer is perfectly suited for intimate dinners and cocktail gatherings.

Only available in the evening, the skyline views impress with the colourful lights of dynamic Southbank. The opportunity for something different continues inside, too, with the option of having our surrounding exhibition spaces open for your guests to peruse.

### Courtyard

Sliding double doors open from the glass-walled Atrium into our sun-drenched Courtyard, a tranquil haven in the middle of the Melbourne Central Business District. Enjoy Champagne and Canapes under the stunning greenery, with glistening fairy lights at your next event.

The Courtyard incorporates our Tribute Garden, inviting curious guests to take a stroll through the moving public artwork and acknowledge the thousands of people who have journeyed to make Victoria home.

### Atrium

This beautiful glass conservatory at the rear of Old Customs House, connects the main building to the Courtyard. The contemporary architectural addition brings the outdoors within, flooding it with natural light while staying protected from the elements. At night, see the city lights twinkle through the transparent roof.



Long Room



Courtyard

# Capacities and Floorplan

Spaces		Area m <sup>2</sup>	Banquet	Cabaret	Theatre	Cocktail	Other
01	Atrium	99	70	56	105	120	82 One Long Table 100 Wedding Ceremony
02	Courtyard	330	150			750	180 Wedding Ceremony
03	Education Centre	60		24	30		
04	Grand Foyer	108	60		80	100	
05	Long Room	355	220	176	300	300	
06	Theaterette	125	70	56	100	100	

First level

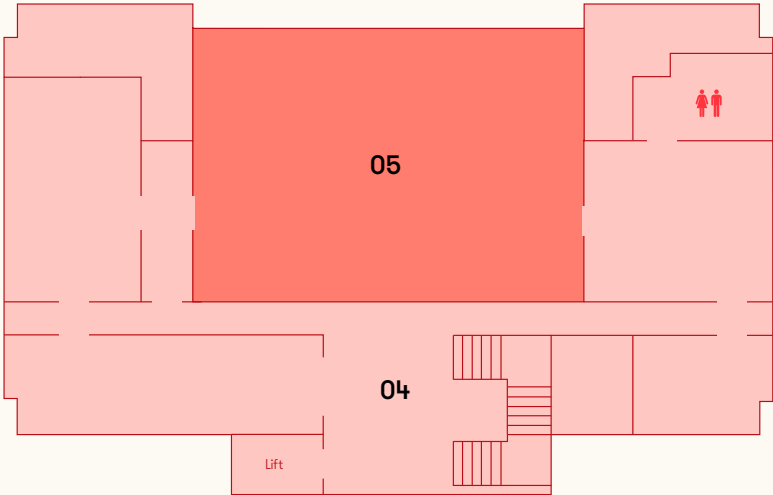

Ground level

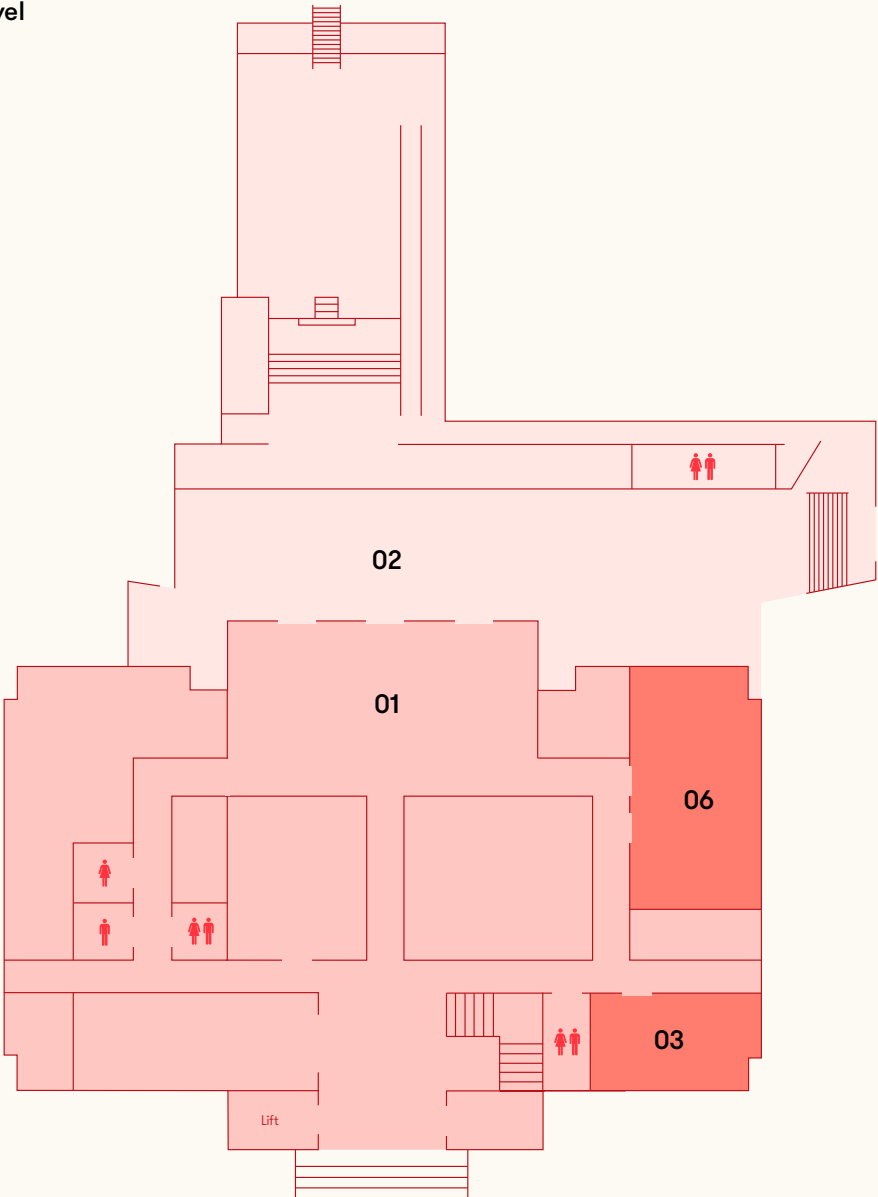





**Immigration Museum**

400 Flinders Street Melbourne  
Situated in the heart of the CBD

**Get in touch to book your next event!**

[mvevents@restaurantassociates.com.au](mailto:mvevents@restaurantassociates.com.au)  
[museumspace.com.au](http://museumspace.com.au)  
03 8341 7400