



CONFERENCE KIT

QT
GOLD COAST

COMPANY PROFILE

Amalgamated Holdings Limited (AHL) is Australia's premier Entertainment, Entertainment Technology and Hospitality and Leisure organisation.

OUR BRANDS

Entertainment

Event Cinemas, Greater Union, Birch Carroll and Coyle, Cinestar Germany, State Theatre

Entertainment Technology

FilmLab Engineering, Edge Digital technology, Cinesound Movietone

Hospitality and Leisure

QT Hotels and Resorts, Art Series Hotels, Rydges Hotels and Resorts, Thredbo Alpine Village, Featherdale Wildlife Park, State Theatre.

QT HOTELS & RESORTS

QT Hotels and Resorts began development in 2011 and form the premium hotel and resort offering of AHL brands. The properties promise to deliver an eclectic design experience, teamed with bold entertainment offerings and unsurpassable service for corporate and leisure travellers. Properties currently in the QT Hotels and Resorts portfolio include: QT Sydney, QT Gold Coast and QT Port Douglas with further plans for development in the coming years.





INTRO

QT Hotels & Resorts has officially unveiled QT Gold Coast, a unique designer resort that celebrates an eclectic design environment and bold entertainment to create an intriguing yet relaxing guest experience.

QT Gold Coast offers a contemporary living space that is a mixture of nostalgic surfer chic meets Miami swim catwalk. Custom furniture, graphics and pops of bold colour are some of the unmissable highlights of the design inspired by the 1950's and 60's with Eames-era chairs, artist crafted feature walls and photographic ceiling mosaics of the Gold Coast through the ages.

The QT Resort experience begins as soon as guests arrive with a concierge and hostess greeting them in quirky, retro outfits. Service is always attentive, combining an upbeat American vibe teamed with a touch of Aussie sincerity.

DESIGN

QT Gold Coast has been designed with a clean getaway feel in mind. Nic Graham, the design mastermind behind the resort, wanted to take visitors on a 50's inspired journey to a cool, clean, beach club-style resort.

Graham runs Nic Graham + Associates studio in Sydney with a small team and has worked in all of the traditional design categories - including architecture, furniture and product design and interiors. Graham wanted to create a 'warmth of cool on a tropical night' atmosphere at the QT Gold Coast resort, and with this in mind his team felt a white base palette was an obvious choice for hot and humid Queensland.

The open spaces and décor have a playful edge, which exude vibrancy and transience – an entrance installation by artist Jennifer Steinkamp, who works with video and new media, creates an intrepid design punch on arrival.

With columns wrapped in rope, bars stacked in river pebbles, nautical lanterns and cocktails under candlelight, QT Gold Coast offers an all-round summer beach vibe.





THE TALENT

With a rich history in hotel design, management and community projects, the management and creative heads of QT Gold Coast have targeted yet varied experience.

David Seargeant
MANAGING DIRECTOR



David Seargeant is Managing Director of QT Hotels and Resorts. David has over 30 years' experience in the hospitality and leisure industries and served as Managing Director of Rydges Hotels group from 1988 to 2002.

Chairman of the National Accommodation Council and Australian Hotels Association, Seargeant has had a lifetime career in hotels having been general manager of 16 different hotel properties. Seargeant is also the Group Managing Director of Amalgamated Holdings Limited, the owners of QT Hotels and Rydges.

Seargeant's vision for QT has been inspired by innovation and creative design found globally in architecture, emerging art, fashion and industrial design.

Nic Graham
PUBLIC AREAS DESIGNER & STYLIST



Nic Graham has made a name for himself delivering the vibrant and transcendent interiors of QT Gold Coast. Graham has been running his own studio in Sydney with a small team and has worked in all of the traditional design categories including architecture, furniture and product design and interiors.



HERE WE ARE

SURFERS PARADISE ACCOMMODATION

If food, wine, music, design, fashion and art are your thing, **QT Gold Coast** is the place for you. Walk in to our Surfers Paradise accommodation and be welcomed by an inspiring open-spaced setting with beautiful artist-crafted features and bold custom lighting.

Features

- 297 spacious guest rooms with ocean or mountain and river views
- Extensive meeting and event venues
- Outdoor heated pool and spa
- Two tennis courts
- 24 hour reception
- Currency exchange
- 24hr business centre
- Concierge – tour desk
- Undercover and valet parking
- Wheelchair access
- Wireless, broadband and dial up internet access
- Distance from Gold Coast International Airport – 22.4 km, 30 minute drive

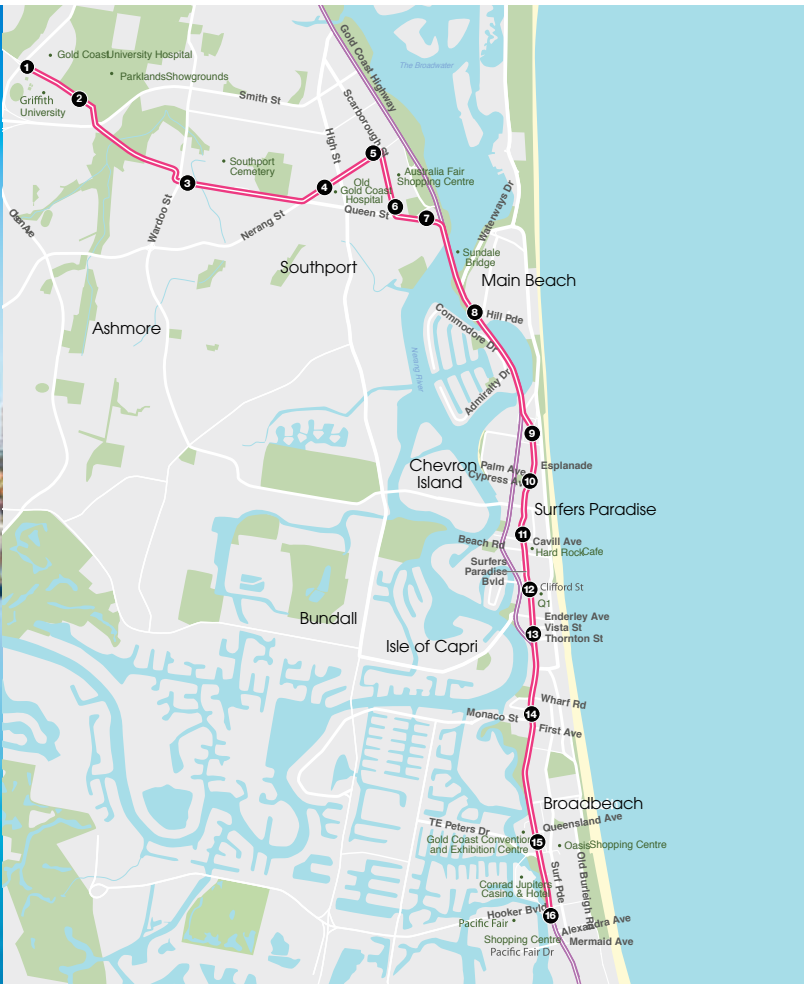

CONNECTING TO THE GOLD COAST CONVENTION CENTRE

Stage one of the Gold Coast light rail is the 13-kilometre corridor connecting Griffith University in Southport to the Gold Coast Convention Centre in Broadbeach.

Passing through the key activity centres of Southport and Surfers Paradise, the light rail (affectionately known as the G:link) will feature 16 stations and utilise 14 light rail vehicles (trams).

Delegates staying at QT Gold Coast will now have easy access to the Gold Coast Convention Centre in Broadbeach – just a short 12 minute commute through 6 quick stops.

Light rail scheduling

The light rail service will run from 5am to 11:50pm, Monday to Thursday, and 24 hours throughout Friday and Saturday until 11:50pm Sunday night.

Please find below the anticipated scheduling:

Time	Monday – Friday	Saturday	Sunday
00:00 – 05:00	No Service	Every 30 mins	Every 30 mins
05:00 – 7:00	Every 15 mins	Every 15 mins	Every 15 mins
7:00 – 19:00	Every 7.5 mins	Every 10 mins	Every 10 mins
19:00 – 24:00	Every 15 min	Every 15 min	Every 15 mins

*Subject to change.



R&R TIME

Experience the best of Gold Coast chic in 297 guest rooms. Sleek designer bathrooms, custom design features and a relaxed beachside feel awaits the sophisticated yet playful guest.

Guest rooms at QT Gold Coast have quirks and nuances ensuring that they feel like a bespoke home away from home. Each room is individually tailored for an unforgettable QT experience boasting luxurious custom made QT king beds, balconies, graphica bathrooms, deluxe amenities, iPod dock, 42 inch flat screen and designer furnishings.

Rooms

- QT King Mountain River View
- QT Twin Mountain River View
- QT King Ocean View
- QT Twin Ocean View
- QT King Suite Ocean View
- Two Storey Penthouse



MEETINGS & EVENTS

Situated on the Surfers Paradise city fringe, just 200 metres from the Pacific Ocean, **QT Gold Coast** cleverly fuses colour and quirk to create extraordinary meetings and events.

The hotel boasts 297 designer guestrooms featuring dazzling ocean or mountain views, plus 3 floors of dedicated conference space including a grand scale Ballroom for up to 750 delegates.

Combine this with the hotels four renowned restaurants and bars: **Bazaar Marketplace**, **Stingray Lounge Bar**, **Fixx Café** and **Yamagen Restaurant** and delegates will be spoilt for choice.

Offering a total of 14 conference and event venues this grand scale, special event property will inspire memorable events delivered through a team of passionate conference and event specialists.





OUTDOOR EVENTS

Soak up the Gold Coast's great outdoors from one of the hotel's unique open-air spaces. Host your guests for a glamorous poolside welcome reception or unveil the latest happenings on the private level two Terrace. The sky's the limit – literally!



CONFERENCE & MEETING ROOM CAPACITIES

GROUND FLOOR

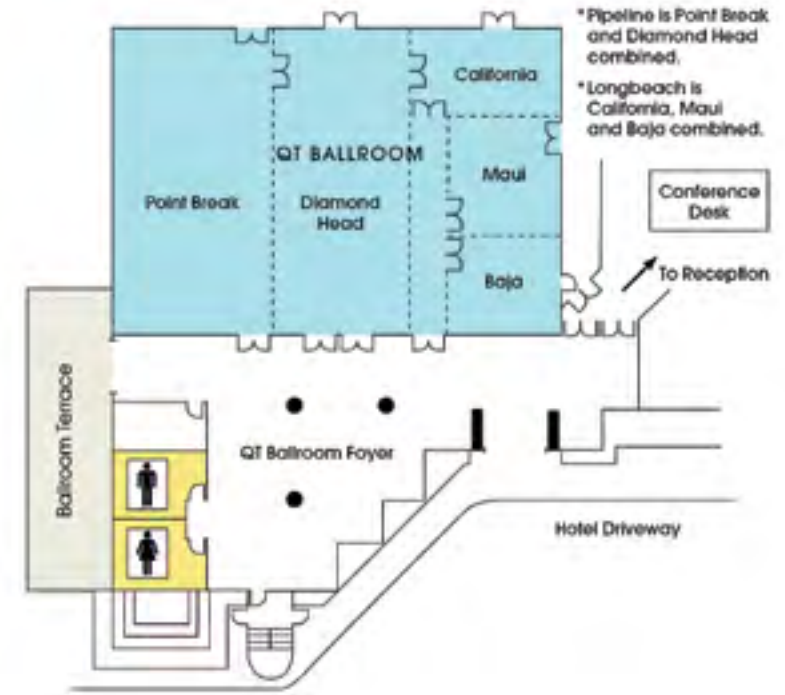

NEW ROOM NAME	AREA (Sq M)	LENGTH & WIDTH (M)	HEIGHT (M)	CLASS ROOM	BOARD ROOM	U SHAPE	THEATRE STYLE	BANQUET STYLE	CABARET (8)	COCKTAIL PARTY
POINT BREAK	210	10.2 x 20.5	6	96	42	50	215	105	80	200
DIAMOND HEAD	184	9 x 20.5	6	96	42	50	215	105	80	200
PIPELINE	394	19.2 x 20.5	6	192	-	56	420	220	180	420
LONGBEACH	205	10 x 20.5	3.5	96	42	50	215	105	80	200
BAJA	42	7.4 x 5.7	3.5	18	18	15	42	20	16	40
MAUI	45	7.4 x 6.2	3.5	27	18	21	65	30	24	60
WAIKIKI	88	7.4 x 11.9	3.5	60	30	36	110	60	48	120
CALIFORNIA	57	5.7 x 10	3.5	24	24	21	50	30	16	50
QT BALLROOM FOYER	230	-	6	-	-	-	-	-	-	300
QT BALLROOM	598	29.2 x 20.5	6	350	-	-	750	540	340	750
POOL DECK	324	-	-	-	-	-	-	110	-	180

LEVEL 1



NEW ROOM NAME	AREA (Sq M)	LENGTH & WIDTH (M)	HEIGHT (M)	CLASS ROOM	BOARD ROOM	U SHAPE	THEATRE STYLE	BANQUET STYLE	CABARET (8)	COCKTAIL PARTY
SUNSET	134	16 x 12	2.9	80	42	40	160	100	75	140
SUNSET 1	63	9 x 7	2.9	30	18	21	55	35	24	50
SUNSET 2	71	9.5 x 7.5	2.9	30	24	26	65	45	35	60
SUNSET LOUNGE	180	-	2.8	-	-	-	150	110	-	150

LEVEL 2

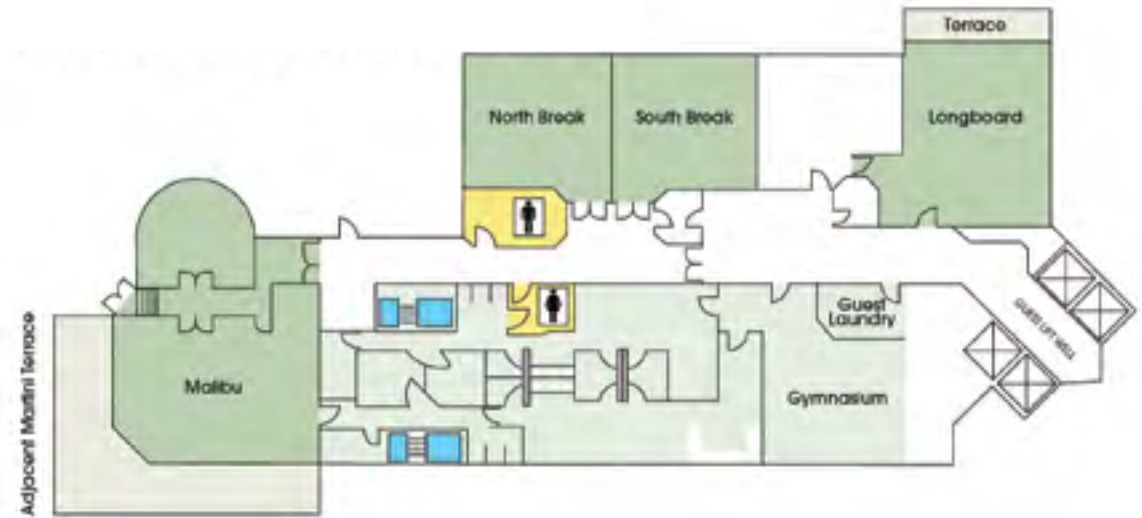

NEW ROOM NAME	AREA (Sq M)	LENGTH & WIDTH (M)	HEIGHT (M)	CLASS ROOM	BOARD ROOM	U SHAPE	THEATRE STYLE	BANQUET STYLE	CABARET (8)	COCKTAIL PARTY
SOUTH BREAK	50	6.7 x 7.6	3	30	18	18	45	35	28	60
NORTH BREAK	50	6.7 x 7.6	3	30	18	18	45	35	28	60
MALIBU	61	9.3 x 6.5	3.5	21	30	25	56	35	28	50
MARTINI TERRACE	120		-	-	-	-	-	200	180	400
MAI TAI MARQUEE	120		-	-	-	-	300	200	180	300
LONGBOARD ROOM	41	7.4 x 5.6	2.8	-	10	-	-	10	-	30+ outside

LEVEL 22



NEW ROOM NAME	AREA (Sq M)	LENGTH & WIDTH (M)	HEIGHT (M)	CLASS ROOM	BOARD ROOM	U SHAPE	THEATRE STYLE	BANQUET STYLE	CABARET (8)	COCKTAIL PARTY
BAYWATCH	45	7.5 x 6.6	2.5	18	18	15	40	30	16	40

WINE AND DINE

STINGRAY

Stingray mixes industrial chic with splashes of pop art to create a Californian oasis on the Gold Coast. Settle in to admire ocean views or be tempted by a cocktail, inspired by one of our 50 in house tequilas.

Designer furniture surrounds the industrial chrome bar, where our talented staff can mix up a drink for any occasion. Add some heat with our Mexican inspired menu for the acclaimed Spicy Buffalo Wings or a Slow Spit Roasted Pork Taco. Available every day from 12pm, you can relax with a Wagyu Steak Burger, or indulge in freshly shucked oysters after dark.

Taco Tuesdays add some midweek fun and our resident DJ kick starts Thursday, Friday and Saturday evenings with a mix of pop, soul and Latin beats. Stingray combines work with pleasure, as the perfect function venue and will add some extra spice to your next celebration.

OPENING HOURS

Every day 12pm to 12am

Available for sole use - POA

STINGRAY





WINE AND DINE

BAZAAR AN INTERACTIVE MARKETPLACE

Bazaar re-creates a traditional marketplace with a twenty-first century twist. Step inside the bustling Gold Coast restaurant and it's clear that it's the produce and flavours which are the heroes.

Immediately to your left is a floor-to-ceiling glass window, allowing diners to peer into a cool room full of premium meats. If you can look past the wood fired pizza ovens, classic pot roasts and refreshing organic salads, you'll see refrigerators almost bursting with colourful, fresh produce. And cornering past the Asian wok stations, the spotlight is on a pedestal of gleaming seafood.

At Bazaar, your plate is your passport and there are no rules on which destinations to explore. With a mosaic of dishes to choose from, many are made to order, whilst others are ready for you peruse at your own pace. Regardless of where you start or finish, each and every dish is accompanied by a passionate chef, eager to explain the intricacies of their creations.

OPENING HOURS

Daily for breakfast and dinner

Available for sole use - POA

BAZAAR

WINE AND DINE

FIXX

Fixx Cafe combines the best of both worlds, with a delicious organic menu as well as indulgent treats for something sweet. Our passionate chefs use only seasonal ingredients, with a menu which is both refreshing and vibrant.

Dress to impress. No bare feet, singlet tops or sleeveless tops for males.

OPENING HOURS

Open seven days from early morning to 3pm.

FIXX





WINE AND DINE

YAMAGEN

Is it cooking or is it performance art? You decide as you savour the mouthwatering flavours of fresh meats prepared by our expert chefs on Yamagen's famous Teppanyaki BBQ Grill.

OPENING HOURS

Tuesday to Saturday – 5:30pm to 9:30pm.
Sundays & Mondays – closed.



spaQ

spaQ is giving a fresh, novel twist to the 'designer spa' concept, which is infused into everything from uniforms to menu options and the 'freshly picked' spa experience philosophy.

Bringing charm to the Gold Coast's local spa terrain, the design of spaQ cleverly fuses colour and quirky features which mirror the vivacious surf-chic personality of the Gold Coast. A canvas of muted tones is festooned with energetic splashes of colour, to create a striking yet tranquil feel to the spa.

Features

- Six treatment rooms, perfect for an indulgent group activity or simply a nice way to relax between meetings
- La Gaia teas which are served, along with an exclusive spaQ blend, in kitsch cups
- Snug sheepskin rugs adorn lounge chairs for luxurious relaxation

**Available for group bookings
and incentives - POA**





CONTACT

QT GOLD COAST CONTACT INFORMATION

7 Staghorn Avenue,
Surfers Paradise QLD 4217 Australia
p +61 7 5584 1200
e reservations_goldcoast@qthotels.com

MEETINGS & EVENTS

p +61 7 5584 1240
e sales_goldcoast@qthotels.com.au

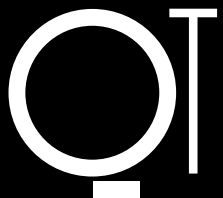

GOLD COAST

qtgoldcoast.com.au